

- Specifications :
- Voltage rating: 600V AC / DC
 - Current rating: 23A AC / DC
 - Withstanding voltage: 2200V AC/minute
 - Temperature range: -40°C~+105°C
 - Insulation resistance: ≥1000MΩ
 - Contact resistance: ≤2mΩ
 - After environmental testing: ≤10mΩ
 - Plug the Pin & Special No.: H-High conductive Brass

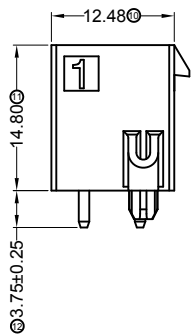

X5700 W V -2*XX -LP SW
 ① ② ③ ④ ⑤ ⑥

- ① Series No.
- ② Category: W-WAFER
- ③ Welding Board Angle: V-Straight 180°
- ④ Row No.-Pin No.: 2*XX-2*02P~2*06P
- ⑤ Material: LP -LCP 94V-0
- ⑥ Plating Category: SW-Matte Tin Plating

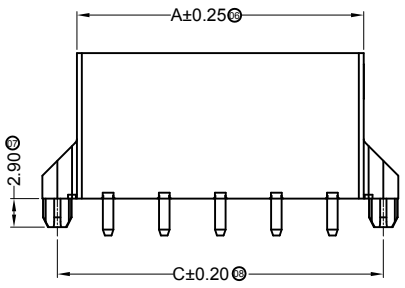
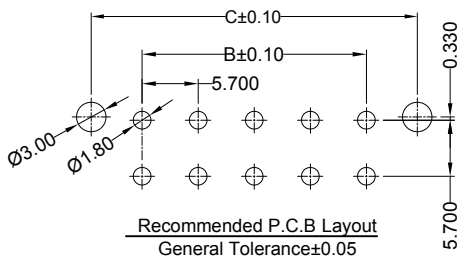
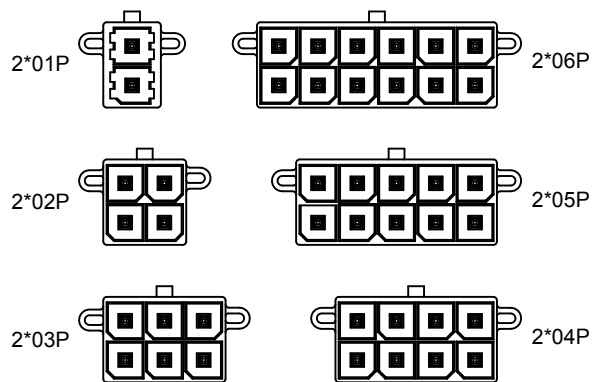
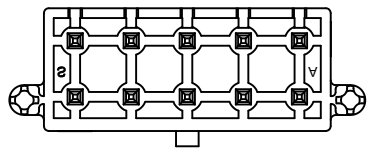

Poles	Dimensions (mm)		
	A	B	C
2*01	8.35	5.70	12.34
2*02	12.05	5.70	16.04
2*03	17.75	11.40	21.74
2*04	23.45	17.10	27.44
2*05	29.15	22.80	33.14
2*06	34.85	28.50	38.84

X5700WV-2*XX-LPSW	High conductive Brass	X5700H	X5700T
PART NO	Material	Suitable XKB Terminal	Suitable XKB Terminal

For and on behalf of
XKB INDUSTRIAL PRECISION CO., LIMITED
 香港星坤工業精密有限公司

△ X						ANGULAR	±5°
△ X						L ≤ 4	±0.2
△ X						4 < L ≤ 16	±0.3
MARK	DESCRIPTION	DATE	REVISED	APPROVED		16 < L ≤ 63	±0.4
						L > 63	±0.5
						UNSPECIFIED TOLERANCES	

DSND		DATE		SCALE: N/A	MODEL TYPE: X5700WV-2*XX-LPSW
DWN		DATE		VIEW:	PART NO.:
CHKD		DATE		UNIT: mm	DWG NO.:
APPD		DATE		SIZE: A4	

XKB INDUSTRIAL PRECISION CO., LIMITED

WEIGHT	SHEET	REVISION
1.0g	1/1	A0